

FIBER TEST

FOCOMM Fusion Splicer



FEATURES

- 4 Motors real core alignment
- Auto splice & auto heat function
- 3-Year extended warranty
- Fully ruggedized for shock, dust, and moisture
- Electrode life around 5000
- times(Replaceable)
- Tool-less electrodes replacement
- 6800mAh High capacity battery
- with 300 splices&shrinks per charge



Durable ceramic
fiber pressure heads



Fast-splicing 8s
Fast-heating 18s



Mirror design makes
uniform light path



The electrodes can
be replaced by screwing
it gently without tools



Special designed V-groove



Special 3-in-1 fiber holder

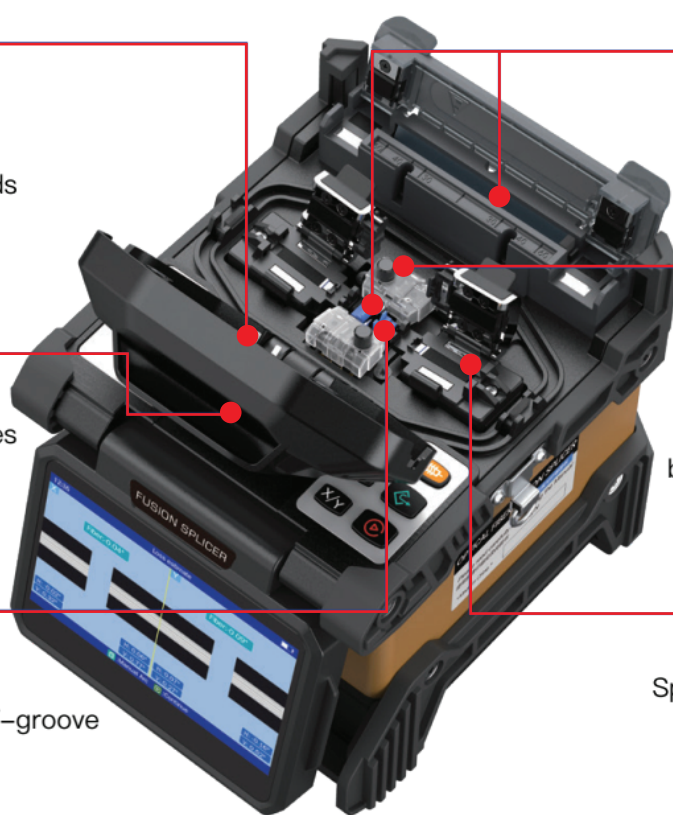

3-IN-1 FIBER HOLDER

Fiber holder suitable for Bare Fiber/ 3.0mm, Jump Fiber/Pigtail and Fiber/Rubber-insulated fiber cable

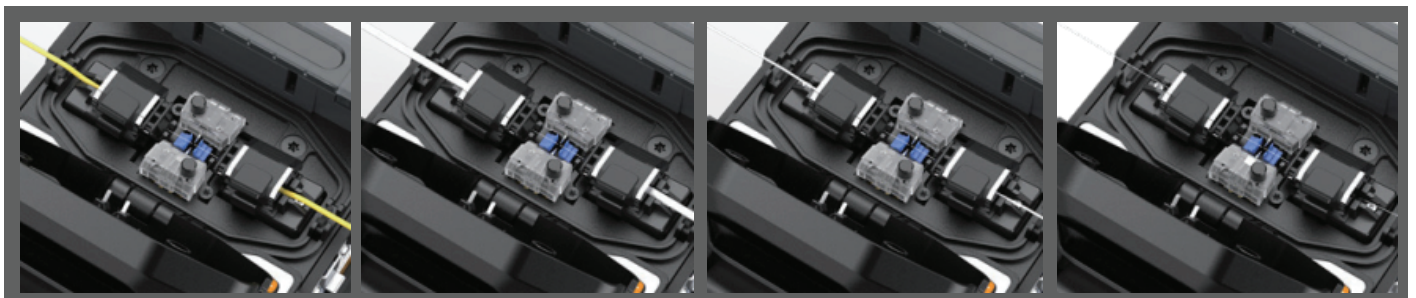

SPECIFICATIONS

Splice Method	Core Alignment
Applicable Fibers	SM(ITU-T G.652&G.657) / MM(ITU-T G.651) / DS(ITU-T G.653) / NZDS(ITU-T G.655)
Compatible Fiber / Cable	0.25-3.0 mm / Rubber-insulated fiber cable
Fiber Holder	Replaceable universal fiber holder
Fiber Diameter	Cladding:80-150μm, Coating: 100-1000μm
Fiber Cleave Lenhth	8~16 mm
Splice Mode	Max 128 modes
Typical Splice Loss	SM: 0.02dB / MM: 0.01dB/DS: 0.04dB/NZDS: 0.04dB / G.657: 0.02dB *
Return Loss	>>60dB
Splicing Time	SM Quick mode: 8 sec/ SM Average: 10 sec
Estimated Splice Loss	Available
Heating time	Quick mode 18 sec.(SM G652 250μm 40mm Sleeve) adjustable
Protection Sleeve Length	20mm, 30mm, 40mm, 50mm, 60mm
Heat Programs	Max 32 modes
Battery Capacity	6800mAh Battery Capacity, Typical 300 Cycles (Splice&Heat) per Charge
Electrode Life	5000 arcs, can be extended by using an electrode grinder
Auto-Start	Splice / Heating
Automatic Fiber Identification	/
Automatic ARC Identification	Automatic arc calibration by air pressure and temperature
Results Storage	The last 10,000 splice records and 2,000 result images
Tension Test	1.96-2.25N
Operating Condition	Altitude: 0-5000m, 0-95% relative humidity, -20-50°C, Max Wind 15m/s
Storage Condition	0-95% relative humidity, -20-60°C
Display	4.3" color high resolution (800 x 480) display
Fiber Magnification	X, Y, XY, X/Y : 320x Magnification
Power Supply	AC 100-240V, DC 9-14V
Terminal	USB2.0
Weight	1.6kg without battery / 1.9kg with battery
Size	143H x 138W x 1550 mm (including rubber bumper)

INTRODUCTION OF FIBER OPTIC CLEAVER

OPERATING PLATFORM

Suitable for different models fiber optic cleavers

Cooling tray can be placed

Highly scalable



INSTALLATION INSTRUCTIONS

OF FIBER OPTIC OPERATING PLATFORM

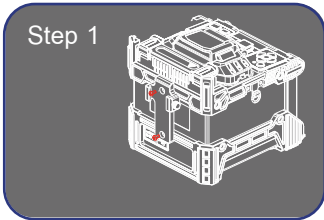

Step 1

Fasten the fixing base to the back of the splicer with screws

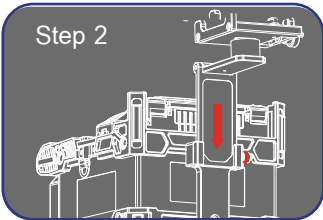

Step 2

Insert the support frame into the socket of the base, adjust it to a proper height, and tighten the screws

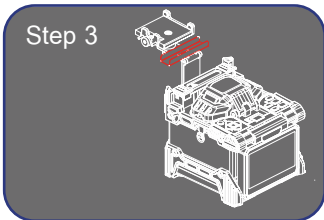

Step 3

Place the cooling tray on the support frame, and make its hole position coincide with the point position on the support plate

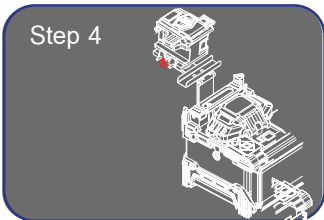

Step 4

Place the fiber cleaver on the operating table, adjust the depth of the screw to make the rubber pad and the cleaver completely fit

STANDARD PACKAGE



- 1.High Precision Fiber Cleaver
- 2.Work Table Carry Case
- 3.Fiber Cleaning Wipes
- 4.Splicing protector sleeves
- 5.Alcohol bottle
- 6.Fiber Stripper
- 7.Flat Cable Stripper
- 8.Fusion splicer
- 9.Power charger
- 10.Cooling Tray
- 11.Battery Pack 6800mAh

ORDER INFOMATION

PRODUCT	PART NUMBER
Fiber Optic Splice , 4 Motor, Splice Time 8S, Heating Time 18S, SM Loss 0.02	TT-SF-240T